



DYNAMIC MOTION system **DMG90**

Change your perspective.

DESCRIPTION

Outstanding. The intelligent technology within the DYNAMIC MOTION system's Actuators delivers a uniquely powerful, responsive driving experience without the need for external Control Boxes.

Compatible with most market-standard spindles through its multifaceted connection point concept – adaptable to both single- and dual-stage applications – the DMG90 is the obvious choice for those who make flexibility their priority. Alongside an optional collision sensor, this 90° cranked motor offers total freedom in design, which can be tailored to fit your needs precisely.

FEATURES

- Intelligent 90° motor for single- and dual- stage table systems
- Integrated Control Unit – no need for external Control Boxes
- Market-leading performance
- Compatibility with bench and conference applications
- Brushless motor technology

TECHNICAL DATA

- Motor Diameter: 40 mm / 1.57 "
- Length: 119.4 mm / 4.691 "
- Nominal Torque: 1.5 Nm @ 114 RPM

Contact Headquarters

LOGICDATA Electronic & Software Entwicklungs GmbH
Wirtschaftspark 18, 8530 Deutschlandsberg, office.at@logicdata.net

North America

LOGICDATA North America Inc., 5300 Broadmoor Ave SE,
Suite D, Grand Rapids, MI 49512, USA, office.na@logicdata.net

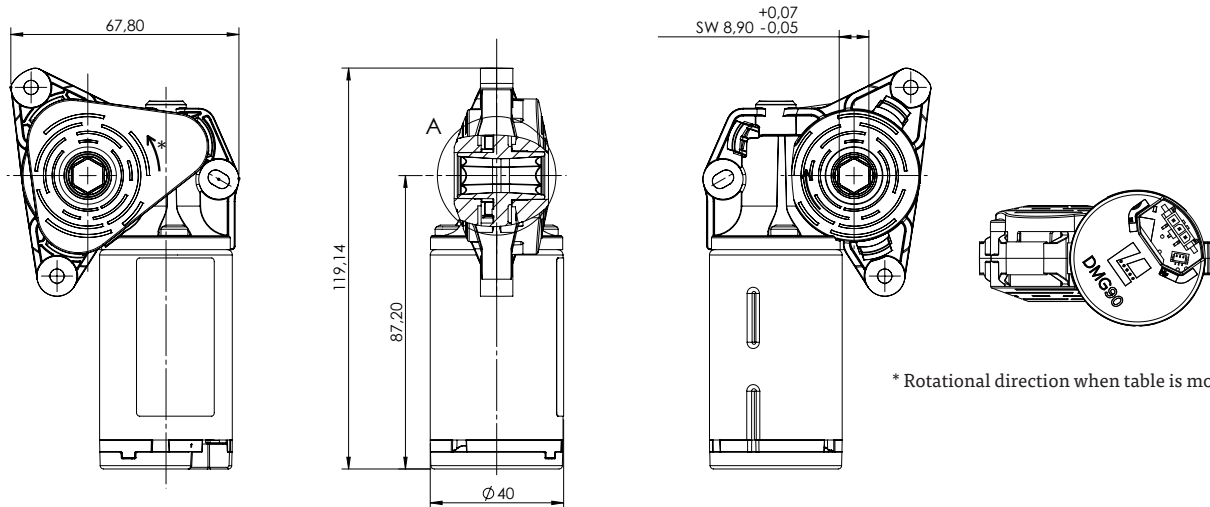

* Rotational direction when table is moving up.

TECHNICAL DATA

Rated Supply Voltage	28.5 V DC
Nominal Torque	1.5 Nm
Nominal Holding Torque	14 Nm
Rotational Speed	114 RPM
Standby Power Consumption	≤ 0.06 W
Ambient conditions during operation	+5 °C to +40 °C at max. 68% relative air humidity (non-condensing), up to an altitude of 2 000 m. Optimal performance +5 °C to +25 °C.
Ambient conditions during transport and storage	-25 °C to +40 °C at max. 68% relative air humidity (non-condensing). +40 °C to +60 °C at max. 32% relative air humidity (non-condensing). Temperatures of more than +40 °C for periods not exceeding 10h. Product must be acclimatised to acceptable operating conditions before assembly. Contact LOGICDATA for exact specifications.
Dimensions (l x w x h)	119.1 mm x 67.8 mm x 40 mm (4.691 " x 2.669 " x 1.575 ")
Diameter Motor Unit	40 mm (1.575 ")
Compatibility	Part of the DYNAMIC MOTION system LOG-PRT-DMS-300 LOG-PRT-DMS-LD (Collision Sensors, with Adapter Cable)
Spindle Attachment Point	Hexagonal. Diameter (from center of sides) 8.9 mm (+0.07 mm / -0.05 mm)
Weight	307 g
Applicable standards	EN 60335-1:2012/A11:2014 EMC directive 2014/30/EU RoHS directive 2011/65/EU REACH 1907/2006 Dodd Frank Act Section 1502 Machinery Directive 2006/42/EC
Order Code	DMG90-a-b <div style="margin-left: 20px;"> Reserved for customer coding (up to 15 characters, optional) Customer code (up to 3 digits, LD is standard) </div>